

BEARTOOTH ELECTRIC MEMBER ENEWS

[View this email in your browser](#)
 Hit Ctrl + in browser to increase screen display



NEW BEC WEBSITE IS LIVE!
CHECK IT OUT @
www.beartoothelectric.com

Visit beartoothelectric.com

We're excited to announce that our new and refreshed website is live!

The updated site includes changes to navigation, with a better user experience for both mobile and desktop versions. We've also improved the structure of our content, so you'll get more from a quick read.

We're proud of the new website and feel it will create the experience you're looking for when you pay us a visit. We hope you take a little time to explore. If you have any comments or suggestions, send us a note with the newly formatted, **Contact us** feature. Enjoy.



THIS IS AN OFFICIAL EMAIL FROM YOUR RURAL ELECTRIC COOPERATIVE. If you do not wish to receive important co-op information by email, [OPT OUT HERE](#).

Make it Your New Year's Resolution to Sign Up for SmartHub!



The NEW SmartHub System Highlights:

1. Improved Navigation
2. New Home Screen Features
 - Make a Payment
 - Setup Auto Payments
 - View Monthly Energy (kWh) and System (KW) Usage and Comparisons
3. And a lot more!

Sign up today--you will need your account number and an email address to enroll. [Click here to visit our website for online, Android and iPhone links](#)

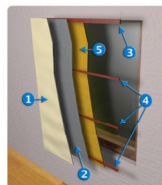

KUME INSULATING CURTAINS

Simple, homemade, effective insulating curtains.

[Watch now to make at home.](#)

BEC CALENDAR JANUARY

2020							JANUARY						
SUN	MON	TUE	WED	THU	FRI	SAT	SUN	MON	TUE	WED	THU	FRI	SAT
			1	2	3	4							
5	6	7	8	9	10	11							
12	13	14	15	16	17	18							
19	20	21	22	23	24	25							
26	27	28	29	30	31								

BOARD MEETING | January 7 | BEC Red Lodge Office | Noon

BILLING STATEMENTS | USPS and e-Mail | January 7 | BEC Red Lodge Office

FINANCE/RISK MANAGEMENT COMMITTEE MEETING | January 24 | BEC Red Lodge Office | 2:00 PM

AUTO PAYMENT PROCESSING | January 27 | BEC Red Lodge Office

BOARD MEETING | January 28 | BEC Red Lodge Office | Noon

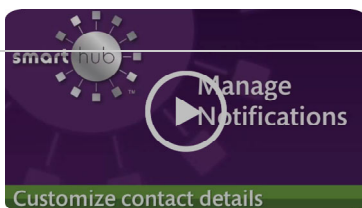

Learn all about SmartHub and see why you should SmartHub today!

Note: this video shows some features BEC is preparing to launch in 2020. Enjoy!

2020 TRUSTEE NOMINATIONS OPEN NOW.

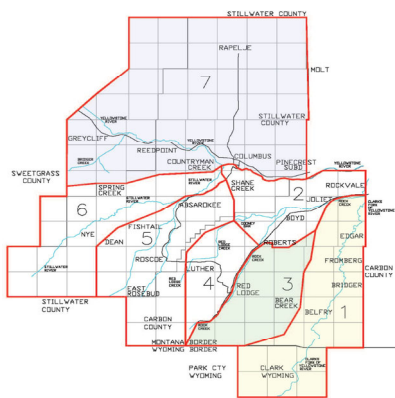

Districts 1, 3 & 7 up for election

The Beartooth Electric Cooperative (BEC) Board of Trustees opened Trustee Nominations for the 2020 elections in Districts 1, 3 and 7. The nomination deadline is March 13, 2020. Elections are held at the annual member meeting, Saturday, May 2, 2020. Nomination petitions are available at the link below or at the BEC Red Lodge office. Please give us a call if you have any questions 406-446-2310.

[Get the Nomination Petition Form Here](#)

BEC Board of Trustees Meeting

Tuesday, January 7, 2020
BEC Red Lodge Office
NOON



Join us for this month's board meeting. Agenda highlights include:

- Rate Design Recommendation to the Board
- 2020 Budget Review and Approval
- NWE OATT Tariff Impact- Bill Pascoe/ Brad Prophet

BEC Member-Owners are encouraged to join board committees of interest. All committee meetings are open and member-owner attendance is welcomed.

All meetings are posted on the BEC website calendar. [Click here for the calendar.](#)

BEC SECURE PAY
Just dial the toll-free number any time, day or night, to manage your account.



Please have your account number or phone number listed on your account available. The first time you call, you will setup your secure account and select a personal identification number (PIN).

BEC Secure Pay allows you to pay your bill with a credit card, debit card, or bank account for a one time or autopay program set up.

VISA MASTERCARD DISCOVER BANK OF AMERICA
888-395-5293

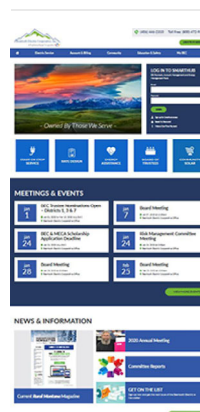

[Visit the BEC website](#)



What do YOU think?

We would like to know how you like BEC's communication through the Rural Montana magazine, billing inserts, website, member newsletter and Facebook? If you would like to provide comment, please consider these options:

Call your [District Trustee](#)
Email bec@beartoothelectric.com
Call us at 406-446-2310
Find us on [Facebook](#)
Attend a board meeting.

And more...

[Access the January 7, 2020 Board Book Here](#)

BEC Unclaimed Capital Credits

Some retired capital credits from previous years remain unclaimed. Capital credits typically go unclaimed when Beartooth Electric Cooperative cannot locate the member to whom the credits are owed. Account holders with unclaimed capital credits, listed alphabetically by last name (or in the case of commercial accounts, by the first letter in the company name), can be found in the link below. You may also call the co-op's office at (406) 446-2310 to see if there are unclaimed credits in your name.



[Unclaimed Capital Credits List - November 2019](#)

Last Call: BEC & MECA Memorial Scholarship Application Deadline is January 24, 2020



Beartooth Electric \$1,000 Scholarship

BEC awards a \$1,000 scholarship to one senior at each of the eleven service area high schools. Scholarship recipients are selected based on a combination of weighted criteria, including financial need, personal statement, academic achievement, extracurricular activities and community service.

The Montana Electric Cooperatives' Association's (MECA) \$500 Memorial Scholarship

The MECA Memorial Scholarship opportunity is also open for application. The Beartooth Electric membership criteria applies for eligibility, and a single candidate to represent BEC in final judging at MECA will be selected by the Beartooth Board of Trustees. Applications must be received at the BEC office by January 24, 2020.

Hurry and submit your application by January 24, 2020.

[Scholarship Applications Here](#)



Beartooth Electric Cooperative, Inc. (BEC) is a not-for-profit company with an office located in beautiful Red Lodge and a crew outpost located in Columbus, Montana. We were incorporated in 1938 and have a long history of service to Stillwater, Sweetgrass, and Carbon counties in Montana along with a portion of Park County in Wyoming. We currently serve over 4,500 members and over 6,000 meters.

To provide our members with reliable, reasonably priced electricity and related services delivered in a safe and efficient manner.

We encourage members to learn about our efforts and utilize this website to stay informed. We supply more than electric energy services. We supply customer service. We are here to serve in any way we can.

Beartooth Electric Cooperative, Inc.
PO Box 1110
1306 N Broadway Ave
Red Lodge, MT 59068
800-472-9821 | 406-446-2310



Copyright © 2020 Beartooth Electric Cooperative. All rights reserved.
Beartooth Electric Cooperative is an equal opportunity employer and provider.
Ebiast Review

Our mailing address is:
Beartooth Electric Cooperative
PO Box 1110, 1306 N Broadway Ave
Red Lodge, MT 59068

[unsubscribe from this list](#) [update subscription preferences](#)

